

配套阀门

MATCHING VALVE



弘特流体
HONGTEFLUID

流体阀门管件集成智造商

INTEGRATED INTELLIGENT MANUFACTURER
OF FLUID VALVES AND FITTINGS



操作原理
Operating principle

- 当流体的压力大于弹簧的抽吸压力时，阀门打开。当两种压力相当时，阀门关闭。更强大的压差也可以使阀门关闭。
- The valve opens when the pressure of the fluid exceeds the pressure exerted by the pump spring. When the two pressures are equalised, the valve closes. A stronger counter-pressure allows the valve to close.

材质
Materials

- 外部构造和轴 AISI 316L
- 弹簧 AISI 301
- 垫圈 EPDM 根据FDA 117.2600
- 表面处理 Ra ≤ 0.8 μm
- Casing/shaft AISI 316L
- Spring AISI 301
- Seal EPDM according to FDA 177.2600
- Surface finishing Ra ≤ 0.8 μm



选项
Options

- 垫圈有NBR, FPM (氟橡胶) 或PTFE, 所有都根据FDA 117.2600
- 连接: 焊接, 螺纹, 卡箍, DIN, SMS RJT, IDF, ISO, 3A
- Seals in NBR, FPM (Viton) or PTFE. All of them according to FDA 177.2600
- Connections: weld, thread, clamp, DIN, SMS, RJT, IDF, ISO, 3A

技术规范
Technical specifications

- 最大压力: 10 bar
- 开启压力: 0.3bar(DN-25)
0.2bar(DN-32/40)
0.1bar(DN-50/100)
- 工作温度: -10°C到+120°C(EPDM)
- Max. pressure 10 bar
- Opening pressure: 0.3 bar (DN-25)
0.2 bar (DN-32/40)
0.1 bar (DN-50/100)
- Working temperature -10°C to +120°C (EPDM)

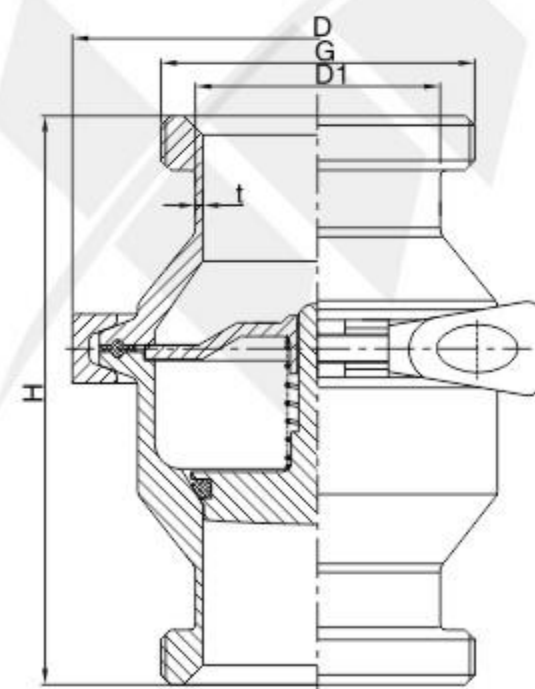
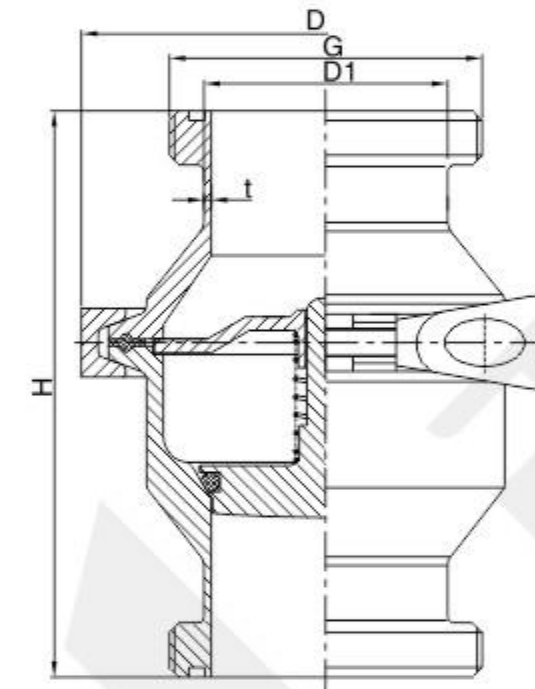
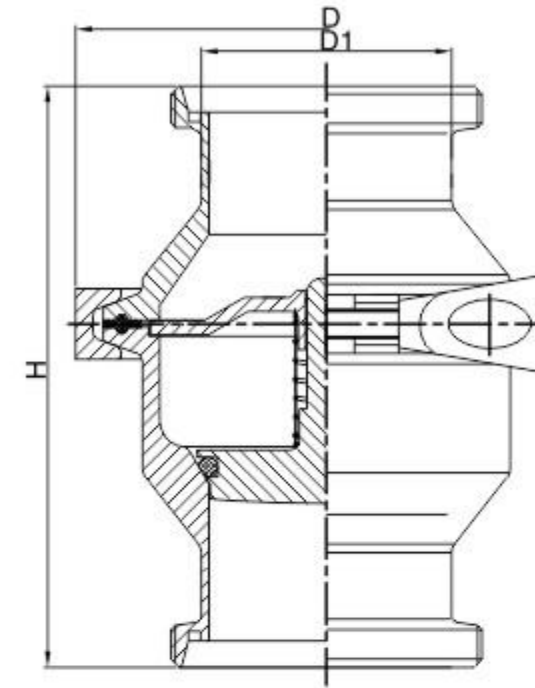

ST-V1040 螺纹式止回阀(DIN)
Threaded Check Valve(DIN)

SIZE	H	D1		D	t	G(RD)
		1	2			
DN15	115	18	19	87	1.5	33.5x1/8
DN20	119	22	23	87	1.5	43.5x1/6
DN25	125	28	29	87	1.5	51.5x1/6
DN32	127	34	35	87	1.5	57.5x1/6
DN40	123	40	41	87	1.5	64.5x1/6
DN50	135	52	53	100	1.5	77.5x1/6
DN65	145	70	-	115	2.0	94.5x1/6
DN80	151	85	-	128	2.0	109.3x1/4
DN100	170	104	-	164	2.0	129.3x1/4

ST-V1041 螺纹式止回阀(SMS)
Threaded Check Valve(SMS)

SIZE	H	D	D1	t	G(RD)
3/4"	115	87	19	1.5	35.5x1/8
1"	119	87	25.4	1.5	39.5x1/6
1 1/4"	127	87	31.8	1.5	59.5x1/6
1 1/2"	127	87	38.1	1.5	69.5x1/6
2"	137	100	50.8	1.5	84.5x1/6
2 1/2"	149	115	63.5	2.0	97.3x1/6
3"	155	128	76.2	2.0	104.3x1/6
3 1/2"	149	128	89	2.0	124.3x1/4
4"	170	164	101.6	2.0	131.3x1/6

ST-V1042 螺纹式止回阀(3A)
Threaded Check Valve(3A)

SIZE	H	D1	t	G
1"	108	25.4	1.65	37.13x1/8 Acme
1 1/4"	113	31.8	1.65	45.9x1/8 Acme
1 1/2"	113	38.1	1.65	50.65x1/8 Acme
2"	126	50.8	1.65	64.1x1/8 Acme
2 1/2"	141	63.5	1.65	77.6x1/8 Acme
3"	152	76.2	1.65	91.1x1/8 Acme
4"	167	101.6	2.1	119.25x1/6 Acme

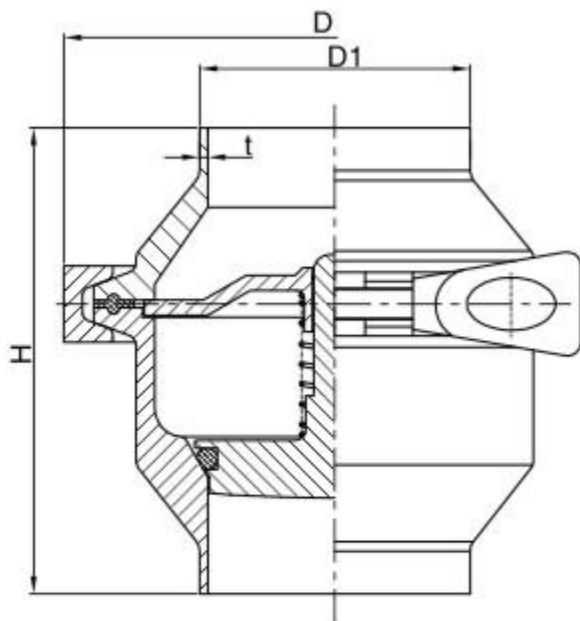

ST-V1043 焊接式止回阀
Welded Check Valve

Size	t	H	D	D1
DN15	1.5	81.0	87.0	18.0
DN20	1.5	81.0	87.0	22.0
DN25	1.5	81.0	87.0	28.0
DN32	1.5	81.0	87.0	34.0
DN40	1.5	81.0	87.0	40.0
DN50	1.5	91.0	100.0	52.0
DN65	2.0	95.0	115.0	70.0
DN80	2.0	101.0	128.0	85.0
DN100	2.0	110.0	164.0	104.0

ST-V1044 焊接式止回阀(ISO/IDF)
Welded Check Valve(ISO/IDF)

Size	t	H	D	D1
3/4"	1.5	81.0	87.0	19.0
1"	1.5	81.0	87.0	25.4
1 1/4"	1.5	81.0	87.0	32.0
1 1/2"	1.5	81.0	87.0	38.1
45	1.5	91.0	100.0	45.0
2"	2.0	91.0	100.0	50.8
57	2.0	91.0	100.0	57.0
2 1/2"	2.0	95.0	115.0	63.5
3"	2.0	101.0	128.0	76.2
3 1/2"	2.0	101.0	128.0	89.0
4"	2.0	110.0	164.0	101.6
	2.0	110.0	164.0	108.0

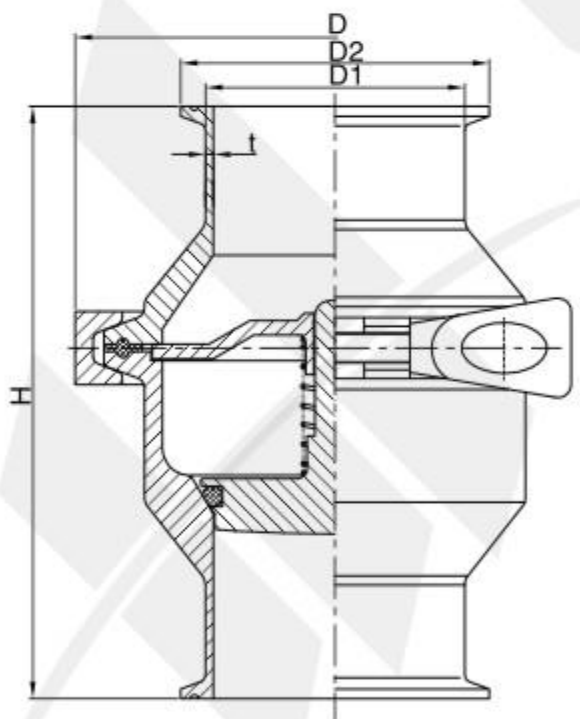

ST-V1045 卡箍式止回阀(DIN)
Clamped Check Valve(DIN)

Size	t	H	D	D1
DN15	1.5	95	87.0	34.0
DN20	1.5	95	87.0	34.0
DN25	1.5	95	87.0	50.5
DN32	1.5	95	87.0	50.5
DN40	1.5	95	87.0	50.5
DN50	1.5	104	100.0	64.0
DN65	2.0	110	115.0	91.0
DN80	2.0	120	128.0	106.0
DN100	2.0	130	164.0	119.0

ST-V1046 卡箍式止回阀(SMS)
Clamped Check Valve(SMS)

Size	t	H	D	D1
1/2"	1.5	95	87.0	50.5
3/4"	1.5	95	87.0	50.5
1"	1.5	95	87.0	50.5
1 1/2"	1.5	95	87.0	64.0
2"	2.0	104	100.0	77.5
2 1/2"	2.0	110	115.0	91.0
3"	2.0	115	128.0	106.0
4"	2.0	130	164.0	119.0

操作原理 Operating principle

- 一般操作条件下，该阀门保持关闭。
- 通过调节带有压力螺母的弹簧，该阀门被校准到一个特定的压力。
- 当管路中的压力超过特定的压力时，阀门打开，让流体通过，以此减少管道系统中的压力。
- 该阀门可以带手柄，从而实现阀门部分开启。当手柄在现场清洗过程中保持开启状态时，清洗产品可以流经阀门。

- Under normal operating conditions, the valve remains closed.
- The specific pressure is set by adjusting the spring with the pressure nut.
- When the pressure in the pipes is above the specific pressure, the valve becomes open automatically to make the liquid pass over in order to reduce the pressure in the pipes.
- The valve can be with handle in order to realize partial open. When the handle remains open on the operation spot, the detergent can flow through the flow valves.

选项 Options

- 连接：卡箍，法兰，螺纹，焊接 DIN SMS RJT IDF 3A
- 垫圈材质：EPDM NBR
- 压力操作范围（改变弹簧）
- 装配上手柄可以部分开启阀门，现场清洗时（与泵通道一起使用）可以让流体通过。
- Connections DIN-IDF-RJT-3A-SMS, Clamp, flanges, Welding, Threaded.
- Material of gasket: EPDM NBR FPM
- Pressure Ranges (changing the spring).
- The assembly with handle can open the valve partially. When CIP (with use of pump passes), the liquid can be flowed through.

技术规范 Technical specifications

- 最大温度：121°C (EPDM) /250°F
- 最大操作压力：弹簧可调节 (0-3bar / 0-6bar / 0-10bar) (0-43,5PSI/0-87PSI/0-145PSI)
- Max. temperature 121°C (EPDM) /250°F
- Max. operating pressure Spring adjustable (0-3bar/0-6bar/0-10bar) (0-43,5PSI/0-87PSI/0-145PSI)

ST-V1067 DIN

DN	d1	手动 H Manual H	气动 H Pneumatic H	l
25	26	219	275	58
40	38	250	305	60
50	50	252	305	65
65	66	284	340	75
80	81	301	355	90

ST-V1068 英寸
INCHES

DN	d1	手动 H Manual H	气动 H Pneumatic H	l
1"	22,1	219	275	58
1 1/2"	34,8	238	305	60
2"	47,5	252	305	65
2 1/2"	60,2	284	340	70
3"	72,9	301	355	90

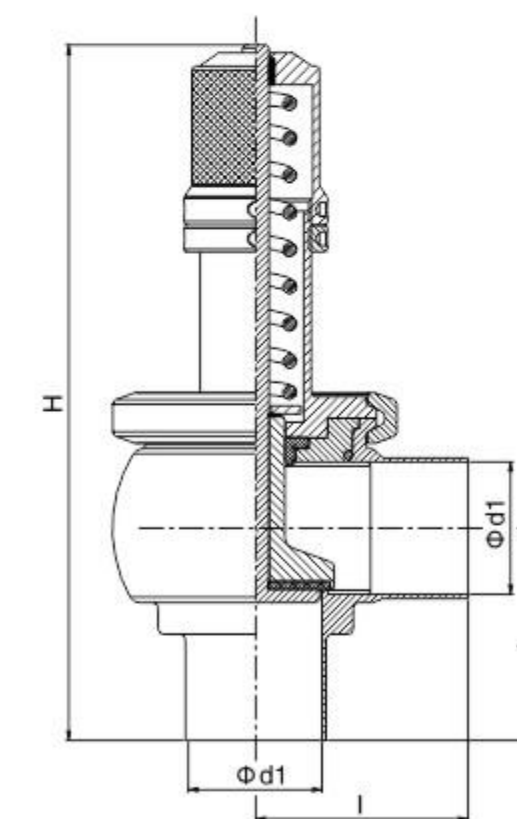

安全阀
Safety Valve

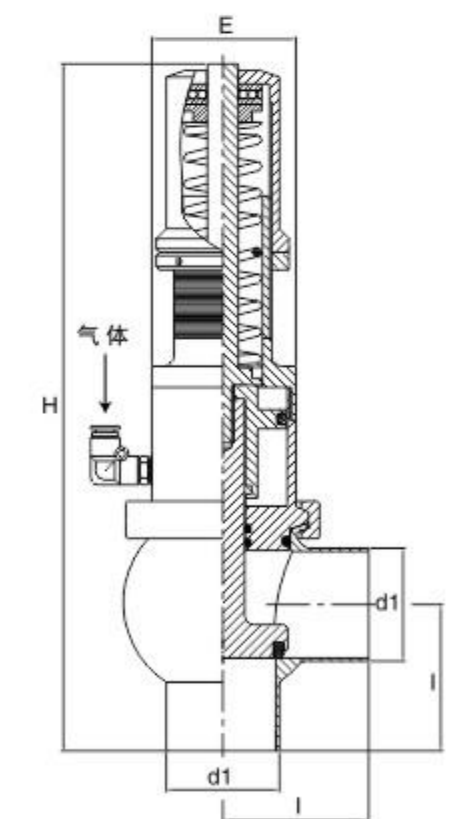

气动安全阀
Pneumatic Safety Valve

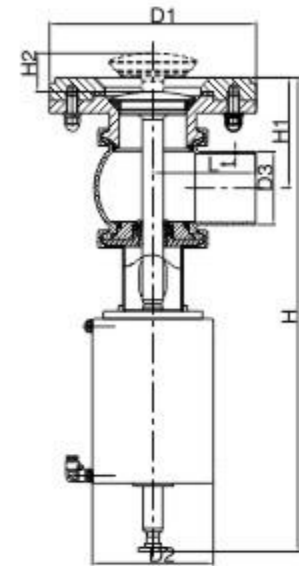

罐底阀法兰连接(DIN)
Tank Bottom Seat Valve(DIN)

ST-V1069

SIZE	D1	D2	D3	1	2	H	H1	H2	L	t
DN40	120	85	40	41	395	85	30	60	1.5	
DN50	130	126	52	53	440	95	46	70	1.5	
DN65	165	126	70	-	450	105	50	80	2.0	
DN80	180	126	85	-	520	120	52	90	2.0	
DN100	215	168	104	-	600	140	62	125	2.0	

ST-V1071

SIZE	D1	D2	D3	H	H1	H2	L
1 1/2"	120	85	38.1	395	85	30	60
2"	130	126	50.8	440	95	46	70
2 1/2"	165	126	63.5	450	105	50	80
3"	180	126	76.2	520	120	52	90
3 1/2"	180	126	89	520	120	52	90
4"	215	168	101.6	600	140	62	125

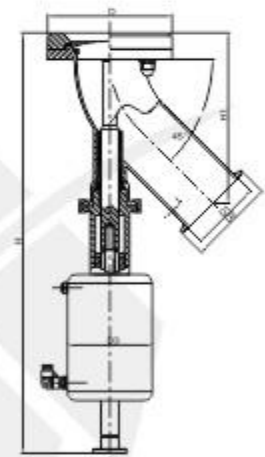

45角度弯头罐底阀
45 Degree Elbow Tank Bottom Seat Valve

ST-V1073

SIZE	D	D1	D2	D3	H	H1	t
DN50	112	52	64	76	338	112.5	1.5
DN65	112	70	77.5	76	365	153.5	2.0

ST-V1075

SIZE	D	D1	D2	D3	H	H1
2"	112	50.8	64	76	338	112.5
2 1/2"	112	63.5	77.5	76	365	153.5

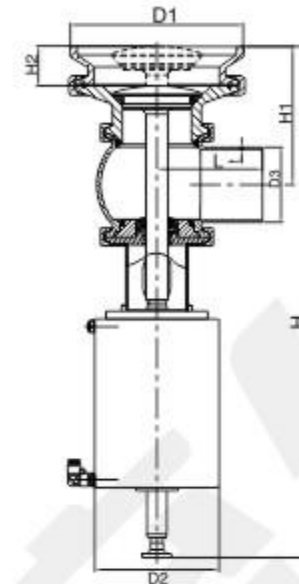

罐底阀卡箍连接(DIN)
Tank Bottom Seat Valve(DIN)

ST-V1070

SIZE	D1	D2	D3	1	2	H	H1	H2	L	t
DN40	70	85	40	41	395	95	30	60	1.5	
DN50	89	126	52	53	440	105	46	70	1.5	
DN65	108	126	70	-	450	115	50	80	2.0	
DN80	127	126	85	-	520	130	52	90	2.0	
DN100	154	168	104	-	600	150	62	125	2.0	

ST-V1072

SIZE	D1	D2	D3	H	H1	H2	L
1 1/2"	70	85	38.1	405	95	30	60
2"	89	126	50.8	450	105	46	70
2 1/2"	108	126	63.5	460	115	50	80
3"	127	126	76.2	530	130	52	90
3 1/2"	127	126	89	530	130	52	90
4"	154	168	101.6	610	150	62	125

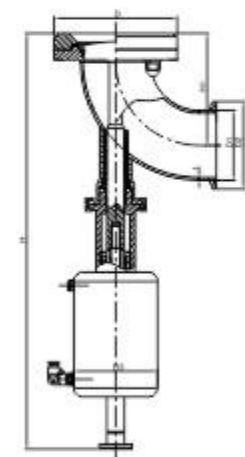

90角度弯头罐底阀
90 Degree Elbow Tank Bottom Seat Valve

ST-V1074

SIZE	D	D1	D2	D3	H	H1	t
DN50	112	52	64	76	338	87	1.5
DN65	112	70	77.5	76	365	121	2.0

ST-V1076

SIZE	D	D1	D2	D3	H	H1
2"	112	50.8	64	76	338	87
2 1/2"	112	63.5	77.5	76	365	121

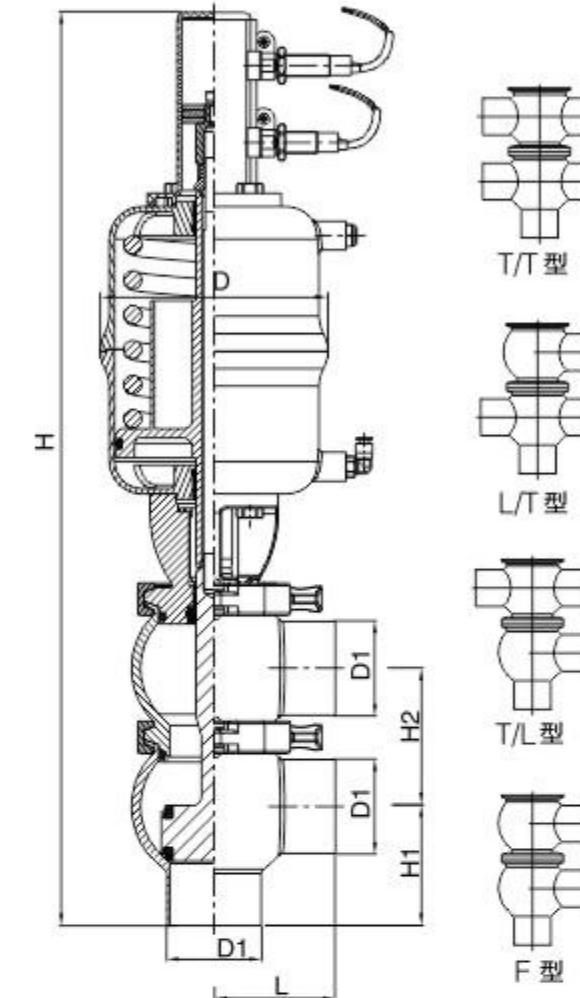

ST-V1077

气动截止换向阀(DIN)
Pneumatic Stop Reversing Valve (DIN)

SIZE	H	H1	H2	t	D1		D	L
					1	2		
DN25	425	58	67	1.5	28	29	85	61
DN32	425	58	67	1.5	34	35	85	61
DN40	425	58	67	1.5	40	41	85	59
DN50	460	66	76	1.5	52	53	126	66
DN65	485	77	88	2.0	70	-	126	77
DN80	620	97	106	2.0	85	-	133	107
DN100	670	106	146	2.0	104	-	170	114

ST-V1078

气动截止换向阀(3A,SMS,ISO,IDF)
Pneumatic Stop Reversing Valve (3A,SMS,ISO,IDF)

SIZE	H	H1	H2	D	D1	L
1"	425	58	67	85	25.4	61
1 1/4"	425	58	67	85	31.8	61
1 1/2"	425	58	67	85	38.1	59
2"	460	66	76	126	50.8	66
2 1/2"	485	77	88	126	63.5	77
3"	580	97	106	126	76.2	107
3 1/2"	620	97	106	133	89	107
4"	670	106	146	170	101.6	114

ST-V1079

气动截止换向阀(DIN)
Pneumatic Stop Reversing Valve (DIN)

SIZE	H	H1	t	D1		D	L
				1	2		
DN25	360	58	1.5	28	29	85	61
DN32	360	58	1.5	34	35	85	61
DN40	360	58	1.5	40	41	85	59
DN50	400	66	1.5	52	53	126	66
DN65	410	77	2.0	70	-	126	77
DN80	525	97	2.0	85	-	133	107
DN100	550	106	2.0	104	-	170	114

ST-V1080

气动截止换向阀(3A,SMS,ISO,IDF)
Pneumatic Stop Reversing Valve (3A,SMS,ISO,IDF)

SIZE	H	H1	D	D1	L
1"	360	58	85	25.4	61
1 1/4"	360	58	85	31.8	61
1 1/2"	360	58	85	38.1	59
2"	400	66	126	50.8	66
2 1/2"	410	77	126	63.5	77
3"	525	97	129	76.2	107
3 1/2"	525	97	170	89	107
4"	550	106	170	101.6	114

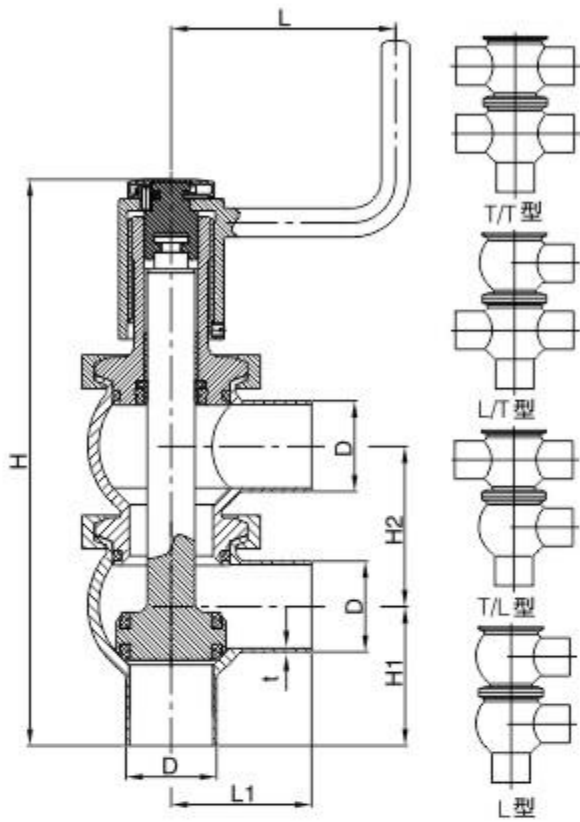

ST-V1081 手动截止换向阀(DIN)
Manual Stop Reversing Valve (DIN)

SIZE	H	H1	H2	t	D		L	L1
					1	2		
DN25	240	58	67	1.5	28	29	94	61
DN32	240	58	67	1.5	34	35	94	61
DN40	240	58	67	1.5	40	41	94	59
DN50	266	66	76	1.5	52	53	94	66
DN65	300	77	88	2.0	70	-	94	77
DN80	347	97	106	2.0	85	-	94	107
DN100	400	106	146	2.0	104	-	100	114

ST-V1082 手动截止换向阀(3A,SMS,ISO,IDF)
Manual Stop Reversing Valve (3A,SMS,ISO,IDF)

SIZE	H	H1	H2	D	L	L1
1"	240	58	67	25.4	94	61
1 1/4"	240	58	67	31.8	94	61
1 1/2"	240	58	67	38.1	94	59
2"	266	66	76	50.8	94	66
2 1/2"	300	77	88	63.5	94	77
3"	347	97	106	76.2	94	107
3 1/2"	347	97	106	89	94	107
4"	400	106	146	101.6	100	114

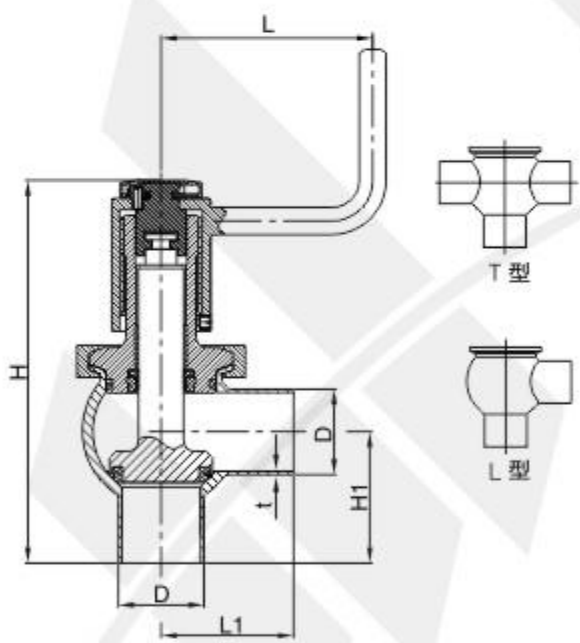

ST-V1083 手动截止换向阀(DIN)
Manual Stop Reversing Valve (DIN)

SIZE	H	H1	t	D		L	L1
				1	2		
DN25	173	58	1.5	28	29	94	61
DN32	173	58	1.5	34	35	94	61
DN40	173	58	1.5	40	41	94	59
DN50	190	66	1.5	52	53	94	66
DN65	212	77	2.0	70	-	94	77
DN80	240	97	2.0	85	-	94	107
DN100	254	106	2.0	104	-	100	114

ST-V1084 手动截止换向阀(3A,SMS,ISO,IDF)
Manual Stop Reversing Valve (3A,SMS,ISO,IDF)

SIZE	H	H1	D	L	L1
1"	173	58	25.4	94	61
1 1/4"	173	58	31.8	94	61
1 1/2"	173	58	38.1	94	59
2"	190	66	50.8	94	66
2 1/2"	212	77	63.5	94	77
3"	240	97	76.2	94	107
3 1/2"	240	97	89	94	107
4"	254	106	101.6	100	114

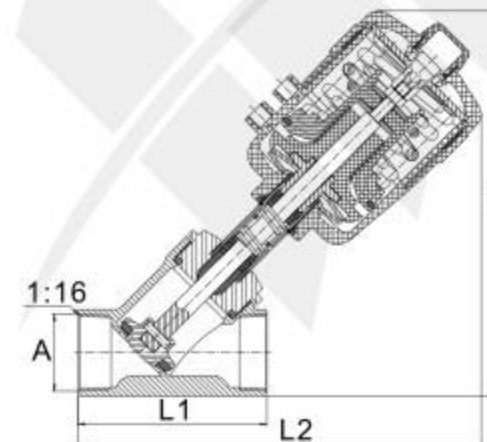

应用
Application

乳制品、制药、啤酒、食品、饲料、环保水处理、化妆品及化工领域；
此阀设计精密，反应敏捷，水击作用极小，可以有更高的流速；
接口为螺纹口(常规)外部先导角座阀，溢流口与滑块间有自调节密封压盖，阀体角座结构可实现较大流量，延长使用寿命，
在同类阀中具有更经济，免维护，易安装，低能耗的特点。

Dairy products, pharmacy, beer, food, feedstuff, environment protection water treatment, cosmetics and chemical engineering field;
This valve has precision design, can respond quickly, with extremely small water hammer action but with higher flow speed; Interface is threaded mouth(regular), external part is firstly guided with corner valve, there is self-adjusting seal gland between overflow port and sliding block, valve body corner seat structure can ensure comparatively large flow capacity, extend service lifetime, with characteristics such as being economical, non-maintenance, easy installation and low energy consumption.

技术参数
Technical parameters

压力范围: 0 ~ 16 bar
介质温度: -10°C ~ +180°C
环境温度: -100°C ~ +600°C
阀门材质: SUS316L
密封材质: 聚四氟乙烯 PTFE
控制气体: 中性气体、空气

Pressure range: 0~16 bar
Medium temperature: -10° C~+180° C
Ambient temperature: -100° C~+600° C
Valve material: SUS316L
Seal material: Polyfluortetraethylene PTFE
Control gas: neutral gas, air

ST-V1085 塑料气动焊接式角座阀
Plastic Pneumatic Welded Angle Seat Valve

SIZE	A	L1	L2	H
DN20	Rc3/4	94	200	185
DN25	Rc1.0	104	210	195
DN40-s	Rc1.5	130	225	212
DN40-b	Rc1.5	130	300	287
DN50	Rc2.0	150	320	306
DN65	Rc2.5	185	347	333

工作原理
Operating Principles

过滤器用于阻止被过滤介质中的固体颗粒进入后续管道的设备，介质从过滤器入口进入一定规格的滤芯后，其较大的固体颗粒或杂质留在滤芯内，过滤后的介质则由出口流出，达到使用要求。当过滤器前后压差超出要求或滤芯损坏时，只须将滤芯取出，清洗干净或更换滤芯，重新安装好便可使用。

Working Principle: filter is used to prevent the solid particles from media mixed into the follow-up pipeline facilities. The larger solid particles or impurities will remaining in it after the media is put into proper filter core, as it can reach the request. When surrounding pressure of the filter exceeds demand, or when the filter core is damaged, you can remove the filter, clean or change new filter core, and re-install it.

过滤器根据使用要求可选用不同的滤芯，其滤芯有三种类型（冲孔板网滤芯，金属丝网滤芯及楔形滤芯）其过滤能力如下：
filters can be matched by different cores according to usage requirements. There are three types of cores (metal mesh, perforated plate and wedge wire) its filtering capabilities are as follows

金属丝网滤芯
Metal Mesh

目数 Mesh	B(mm)	有效面积 Useful surface(%)
30	0,55	48
40	0,40	46
60	0,30	52,6
80	0,20	42
100	0,15	36,2
165	0,10	45,4

冲孔板网滤芯
Perforated Plate

A 孔径	有效面积 Useful surface(%)
0,5	15
1	28
1,5	33
2	30
3	33
5	46

楔形滤芯
Wedge Wire

目数 Mesh	C(mm)	有效面积 Useful surface(%)
30	0,55	48
40	0,40	46
60	0,30	52,6
80	0,20	42
100	0,15	36,2
165	0,10	45,4



角式过滤器
Angle-type Strainer

直通过滤器
Straight Strainer



卫生级微孔过滤器
Sanitary Micro-Filter

Y型过滤器
Y-type Strainer

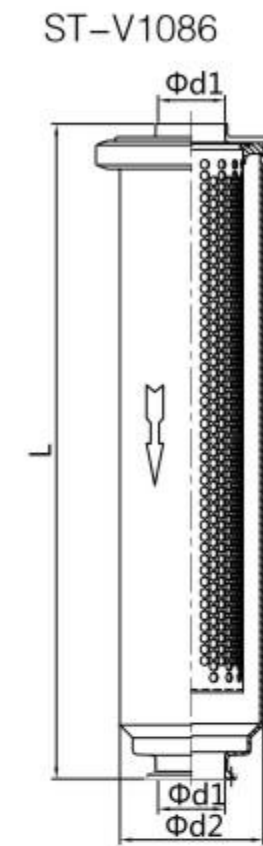

ST-V1086
焊接式直通过滤器
Welded Straight Strainer

DN	D	d2	L
25	28	70	386
32	34	70	472
40	40	70	648
50	52	70	798
65	70	114.3	129.0
80	85	114.3	139.7
100	104	139.7	198

Size	D	d2	L
1"	25	70	377
1-1/2"	38	70	462
2"	51	70	637
2-1/2"	63	114.3	784
3"	76	114.3	784
4"	102	139.7	784

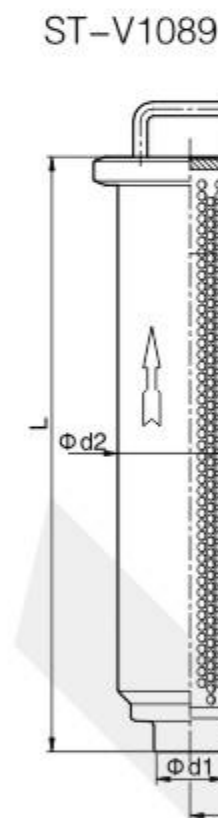

ST-V1089
焊接角式过滤器
Welded angle-type Strainer

DN	D	d2	A	B	L
25	28	70	75	250	306
32	34	70	75	250	306
40	40	70	75	300	406
50	52	70	75	300	406
65	70	114.3	100	380	503
80	85	129.0	110	420	561
100	104	139.7	125	500	660

Size	D	d2	A	B	L
1"	25	70	75	250	306
1-1/2"	38	70	75	250	306
2"	51	70	75	300	406
2-1/2"	63	114.3	100	380	503
3"	76	114.3	100	420	561
4"	102	139.7	125	500	660

ST-V1087

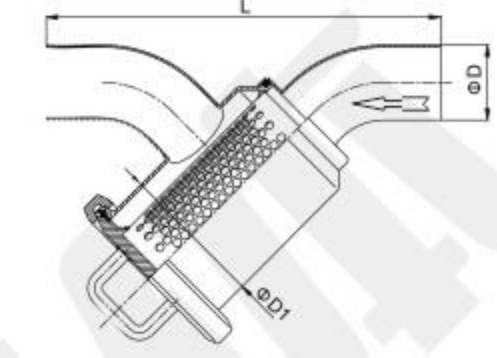

ST-V1088

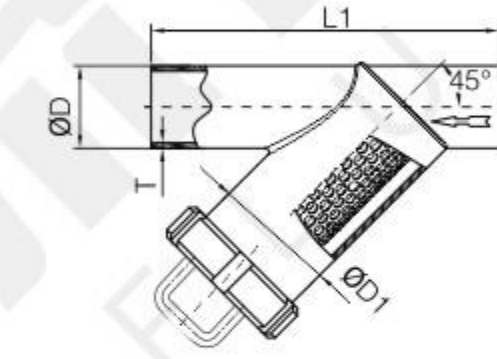

焊接式Y型过滤器
Welded Y-type Strainer

DN	D	D1	L	L1
25	28	76.2	235	125
32	34	76.2	240	140
40	40	101.6	260	165
50	52	101.6	280	195
65	70	114.3	320	30
80	85	114.3	375	280
100	104	154	400	340

Size	D	D1	L	L1
1"	25	76.2	213	123
1-1/2"	28	101,6	242	144
2"	51	114,3	300	195
2-1/2"	63	114,3	348	210
3"	76	154	378	240
4"	102	154	468	340

空气呼吸器 REBREATHER

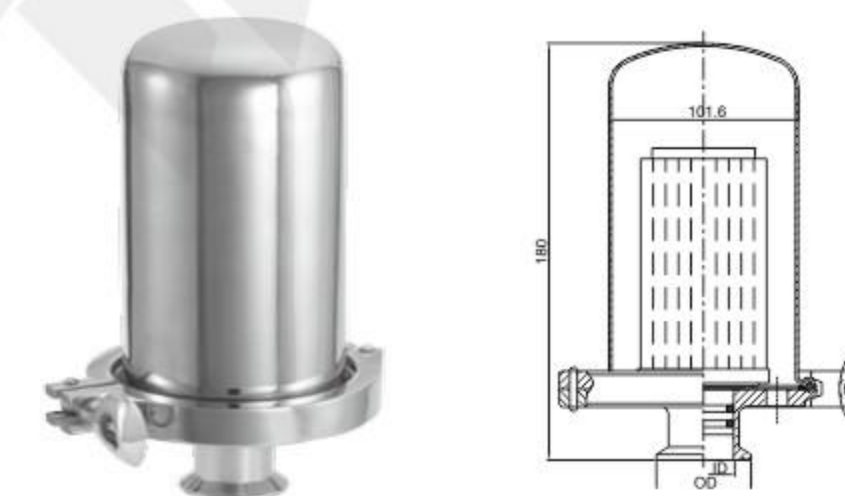

ST-V1090

Size	ID	OD
1"	22	50.5
1-1/4"	29	50.5
1.5"	35	50.5
2"	48	64

材质
Material

- 阀体:AISI 316L
- 手柄:AISI 304
- 密封圈: MVQ EPDM

- Valve body:AISI 316L
- Handle:AISI 304
- Gasket: MVQ/EPDM

技术规范
Technical specification

- 最大压力:600kpa(6bar)
- 最高温度:130°C
- 干蒸汽:(2bar)121°C
- 连接方式: 螺纹, 卡箍, 焊接

- Max.working pressure:600kPa(6bar)
- Temperature
- Max.temperature:130° C
- Dry steam:(2bar)121° C
- Connections: thread, clamp, weld

建议:消毒200次,更换密封圈

Ordering:

It is recommended that the membrane be changed every 200 sterilizations.

技术参数
Technical specification

- 接口方式: 螺纹, 卡箍, 焊接
- 最大压力: 10bar 145psi
- 最小压力: 真空
- 适用温度: -10°C 50° F至 120°C /248°C
- 阀体材质: AISI 304 AISI 316L
- 密封材质: PTFE
- Connections: thread, clamp, weld
- Max. pressure: 10bar 145psi
- Min. pressure: vacuum
- emperature: -10°C 50° F至120°C /248°C
- Body material: AISI304 AISI316L
- Seal material: PTFE

- 该取样阀接口方式: 螺纹, 卡箍, 焊接
- 规格:1/4",3/8",1/2",3/4"
- 密封材质:PTFE符合FDA177.2600
- 垫圈材质:EPDM NBR FPM 符合FDA177.2600
- 最高压力:10Bar
- 最高温度:120°C
- Connections: thread, clamp, weld
- Size: 1/4 " , 3/8 " , 1/2 " , 3/4 "
- Seal material: PTFE in accordance with FDA177.2600
- Max. pressure: 10bar
- Max. Temperature: 120°C

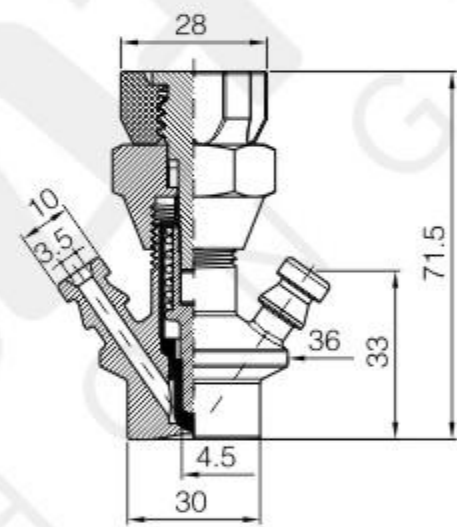

自动回位式焊接无菌取样阀
Automatic return type welded aseptic sampling valve

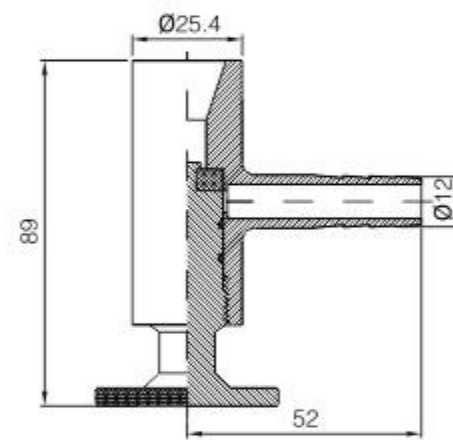

焊接式取样阀
Welded Sampling Valve

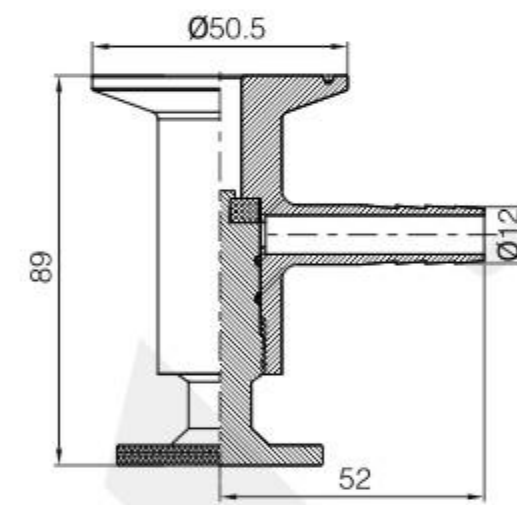

卡箍式取样阀
Clamped Sampling Valve

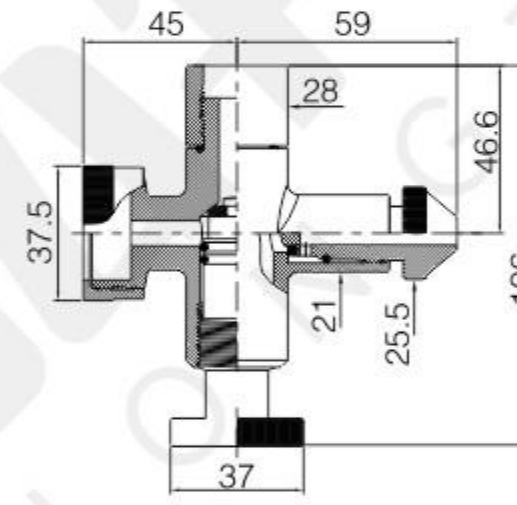

液位计
Level Gauge

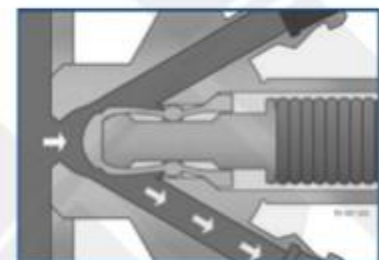

开启阀门, 取样
Open valve, Sampling.

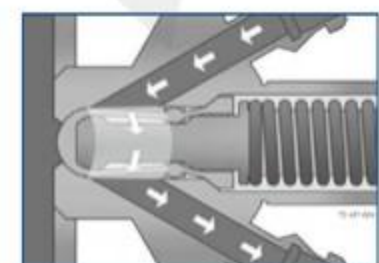

关闭阀门, 消毒
Closed valve, Sterilizing.

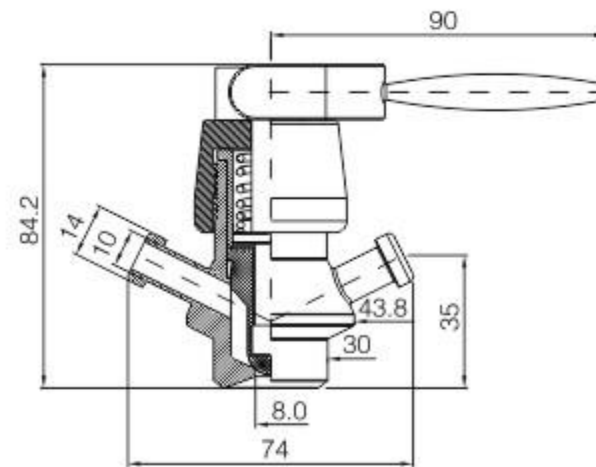

板手式焊接无菌取样阀
Turning handle type welded sampling valve

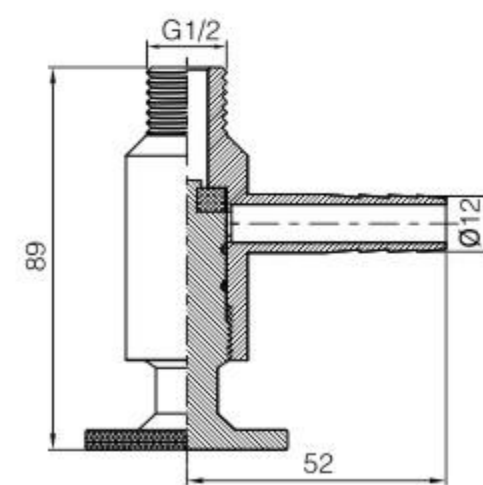

螺纹式取样阀
Thread Sampling Valve
Hose ferrule



可观察玻璃管
Transparent Glass Tube

旋转式清洗球
Rotary Cleaning Ball

ST-V1091 螺纹式
Threaded

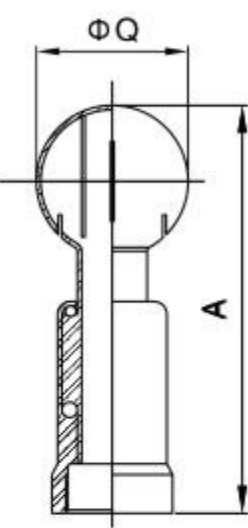

Size	A	Q
1"	140.0	53.0
1 1/4"	160.0	53.0
1 1/2"	170.0	63.0
2"	192.0	76.0
2 1/2"	220.0	91.0

技术参数 Technical parameter

Size	Pressure (bar)	Cleaning radius (m)	Fluxation m ³ /h
1"-1.5"	2	1.25	12
2"	2	1.5	38
2.5"	2	2.0	38

ST-V1092 卡箍式
Clamped

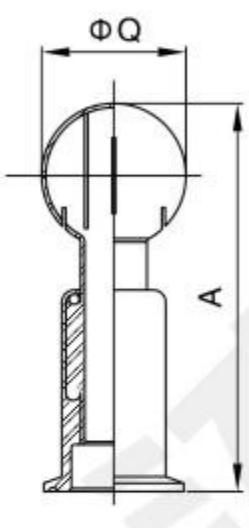

Size	A	Q
1"	138.0	53.0
1 1/4"	138.0	53.0
1 1/2"	138.0	53.0
2"	168.0	63.0
2 1/2"	190.0	76.0

技术参数 Technical parameter

Size	Pressure (bar)	Cleaning radius (m)	Fluxation m ³ /h
1"-1.5"	2	1.25	12
2"	2	1.5	38
2.5"	2	2.0	38

ST-V1093 插销式
Bolted

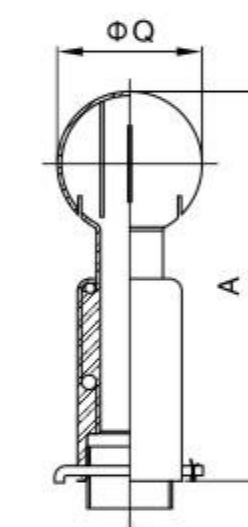

Size	A	Q
1"	135.0	53.0
1 1/4"	137.0	53.0
1 1/2"	137.0	53.0
2"	168.0	63.0
2 1/2"	190.0	76.0

技术参数 Technical parameter

Size	Pressure (bar)	Cleaning radius (m)	Fluxation m ³ /h
1"-1.5"	2	1.25	12
2"	2	1.5	38
2.5"	2	2.0	38

ST-V1094 焊接式
Welded

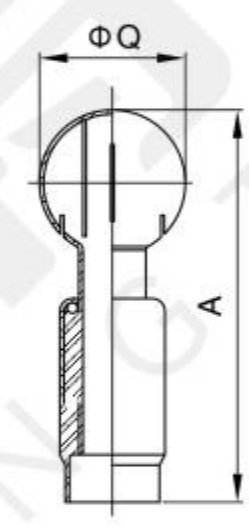

Size	A	Q
1"	143.0	53.0
1 1/4"	145.0	53.0
1 1/2"	145.0	53.0
2"	180.0	63.0
2 1/2"	200.0	76.0

技术参数 Technical parameter

Size	Pressure (bar)	Cleaning radius (m)	Fluxation m ³ /h
1"-1.5"	2	1.25	12
2"	2	1.5	38
2.5"	2	2.0	38

固定式清洗球
Fixed Cleaning Ball

ST-V1095 螺纹式
Threaded

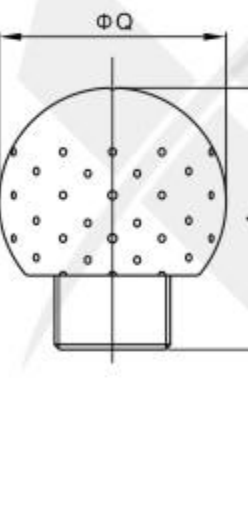

Size	A	Q
1"	72.0	63.0
1 1/4"	85.0	76.0
1 1/2"	87.0	76.0
2"	102.0	91.0

技术参数 Technical parameter

Size	Pressure (bar)	Cleaning radius (m)	360° /180° Fluxation m ³ /h
1"	2.5	1.0-1.25	17/10
1.1/4-1.1/2"	2.5	1.25-1.75	23/17
2"	3.5	2.0-3.0	55/38
2 1/2"	3.5	3.0-3.5	58/41

ST-V1096 卡箍式
Clamped

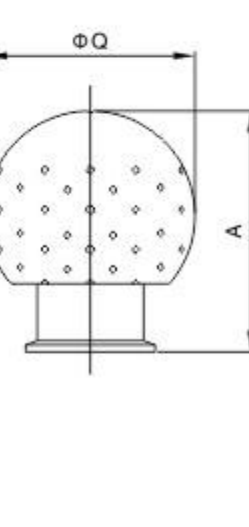

Size	A	Q
1"	80.0	63.0
1 1/4"	93.0	76.0
1 1/2"	93.0	76.0
2"	108.0	91.0
2 1/2"	115.0	100.0

技术参数 Technical parameter

Size	Pressure (bar)	Cleaning radius (m)	360° /180° Fluxation m ³ /h
1"	2.5	1.0-1.25	17/10
1.1/4-1.1/2"	2.5	1.25-1.75	23/17
2"	3.5	2.0-3.0	55/38
2 1/2"	3.5	3.0-3.5	58/41

固定式清洗球
Fixed Cleaning Ball

ST-V1097 焊接式
Welded

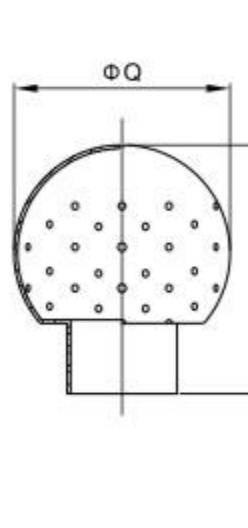

Size	A	Q
1"	72.0	53.0
1 1/2"	85.0	63.0
2"	87.0	91.0
2 1/2"	102.0	100.0

技术参数 Technical parameter

Size	Pressure (bar)	Cleaning radius (m)	360° /180° Fluxation m ³ /h
1"	2.5	1.0-1.25	17/10
1 1/4-1 1/2"	2.5	1.25-1.75	23/17
2"	3.5	2.0-3.0	55/38
2 1/2"	3.5	3.0-3.5	58/41

ST-V1098 插销式
Bolted

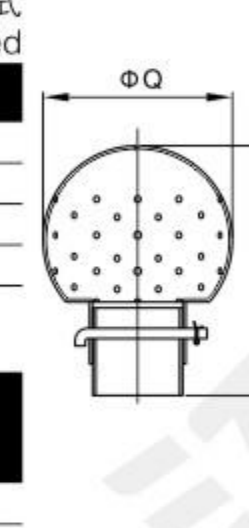

Size	A	Q
1"	95.0	63.0
1 1/2"	110.0	76.0
2"	125.0	91.0
2 1/2"	135.0	100.0

技术参数 Technical parameter

Size	Pressure (bar)	Cleaning radius (m)	360° /180° Fluxation m ³ /h
1"	2.5	1.0-1.25	17/10
1 1/4-1 1/2"	2.5	1.25-1.75	23/17
2"	3.5	2.0-3.0	55/38
2 1/2"	3.5	3.0-3.5	58/41

旋转式清洗器
Rotary Cleaner

ST-V1099 螺纹式
Threaded

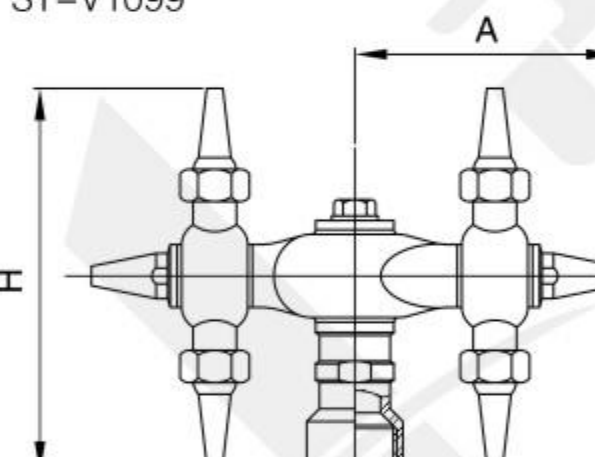

技术参数 Technical parameter

Size	A	H	Pressure (bar)	Cleaning radius (m)	Fluxation m ³ /h
1"	118.0	165.0	1.5-2.0	2.0-3.0	23
1 1/4-1 1/2"	142.0	189.0	1.8-2.5	2.5-3.0	38
2"	145.0	191.0	2.5-3.0	3.5-4.0	60

ST-V1100 插销式
Bolted

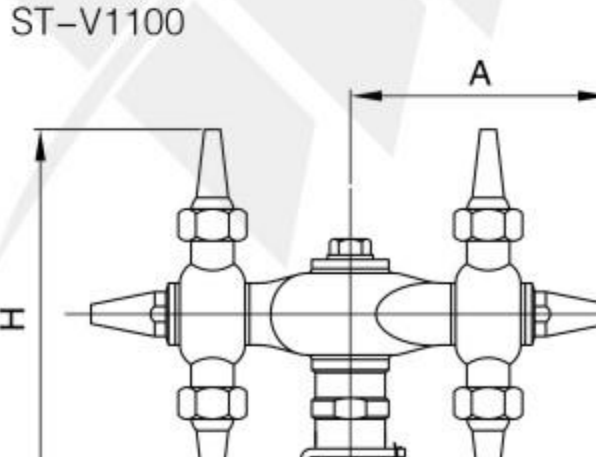

技术参数 Technical parameter

Size	A	H	Pressure (bar)	Cleaning radius (m)	Fluxation m ³ /h
1"	118.0	175.0	1.5-2.0	2.0-3.0	23
1 1/4-1 1/2"	142.0	200.0	1.8-2.5	2.5-3.0	38
2"	145.0	205.0	2.5-3.0	3.5-4.0	60

卫生级管支架系列
SANITARY PIPE HOLDERS

ST-F2023

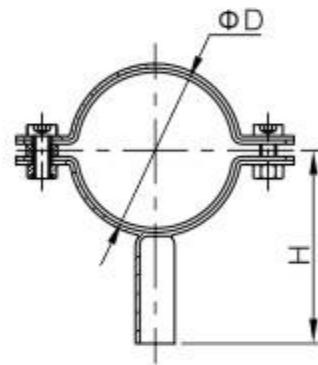

圆形管支架
Bolt Round Pipe Holder

Size	D	H
1/2"	12.7	58.4
3/4"	19.1	62.5
1"	25.4	65.7
1 1/2"	38.1	72
2"	50.8	78.4
2 1/2"	63.5	84.8
3"	76.2	91
4"	101.6	103.8
5"	129	117.5
6"	154	130
8"	204	155
10"	254	180
12"	304	205

ST-F2027

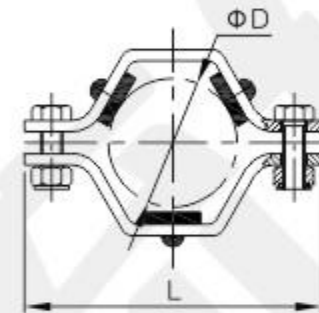

ST-F2028

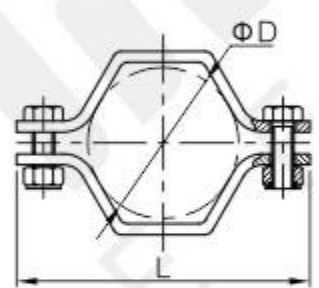

六角型管支架
Hexagon Pipe Holder

Size	D	L
1"	25.4	87
1 1/2"	38.1	101.6
2"	50.8	114.3
2 1/2"	63.5	120.6
3"	76.2	139.7
4"	101.6	171.4

ST-F2024

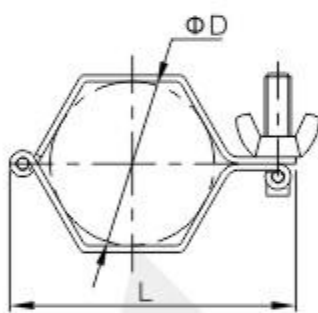

六角型管支架
Hexagon Pipe Holder

Size	D	L	H
1"	25.4	87	28
1 1/2"	38.1	101.6	40
2"	50.8	114.3	52
2 1/2"	63.5	120.6	66
3"	76.2	139.7	77
4"	101.6	171.4	104

ST-F2025

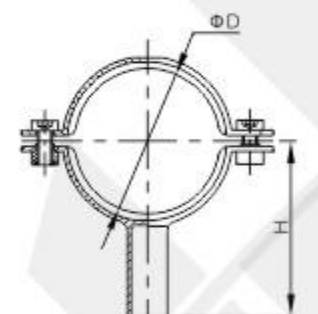

圆形管支架
Bolt Round Pipe Holder

Size	D	L
1"	25.4	61
1 1/2"	38.1	76
2"	50.8	90
2 1/2"	63.5	106
3"	76.2	120
4"	101.6	146

ST-F2026

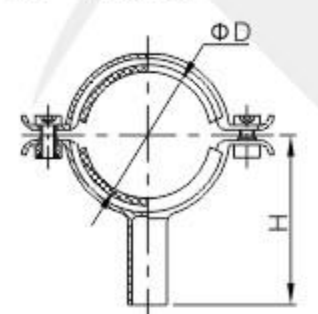

ST-F2029

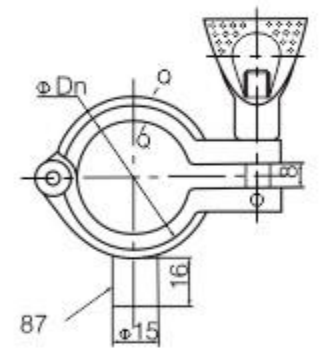

重型管支架
Heavy Duty Pipe Holder

Size	D
1"	25.4
1 1/4"	31.8
1 1/2"	38.1
2"	50.8
2 1/2"	63.5
3"	76.2
3 1/2"	89
4"	101.6

ST-F2030

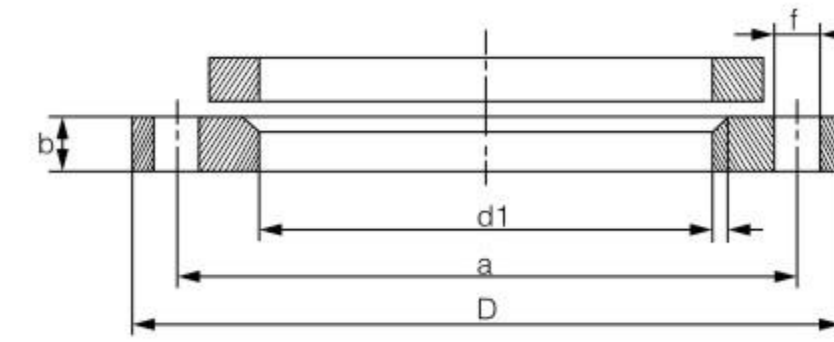
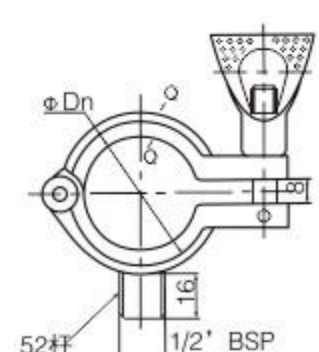

Nominal Diameter	Tube		D	Flange			Bolt hole	Number	Screw	d2	Flange Weight (7.85 Kg/dm ³)
	ISO Series1	DIN Series2		d1	d6	k					
15	-	20	95	22	14	65	3	4	M12	14	0.689
20	-	25	105	28	14	75	3	4	M12	14	0.806
25	-	30	115	33	16	85	4	4	M12	14	1.11
32	-	38	140	42	16	100	4	4	M16	18	1.64
40	-	44.5	150	50	16	110	4	4	M16	19	1.86
50	-	57	165	62	16	125	5	4	M16	18	2.2
65	-	-	185	81	16	145	5	4	M16	18	2.62
80	-	-	200	94	18	160	5	8	M16	18	3.32
100	-	108	220	11+	18	180	5	8	M16	18	3.67
125	-	133	250	138	18	210	5	8	M16	18	4.54
150	-	159	285	164	18	240	5	8	M20	22	5.6
200	-	-	340	225	20	295	5	8	M20	22	7.46
250	-	267	395	273	22	350	5	12	M20	22	10.3
300	323.9	-	445	329	26	400	5	12	M20	22	14
350	355.6	-	505	362	28	460	6	16	M20	22	18.5
400	406.4	-	565	413	32	515	6	16	M24	26	25
(450)	457	-	615	467	38	565	6	20	M24	26	30.6
500	508	-	670	517	38	620	6	20	M24	26	37
600	610	-	780	618	44	725	7	20	M27	30	56.3
700	711	-	895	721	50	840	7	24	M27	30	80.4
800	813	-	1015	824	56	950	7	24	M30	33	113.2

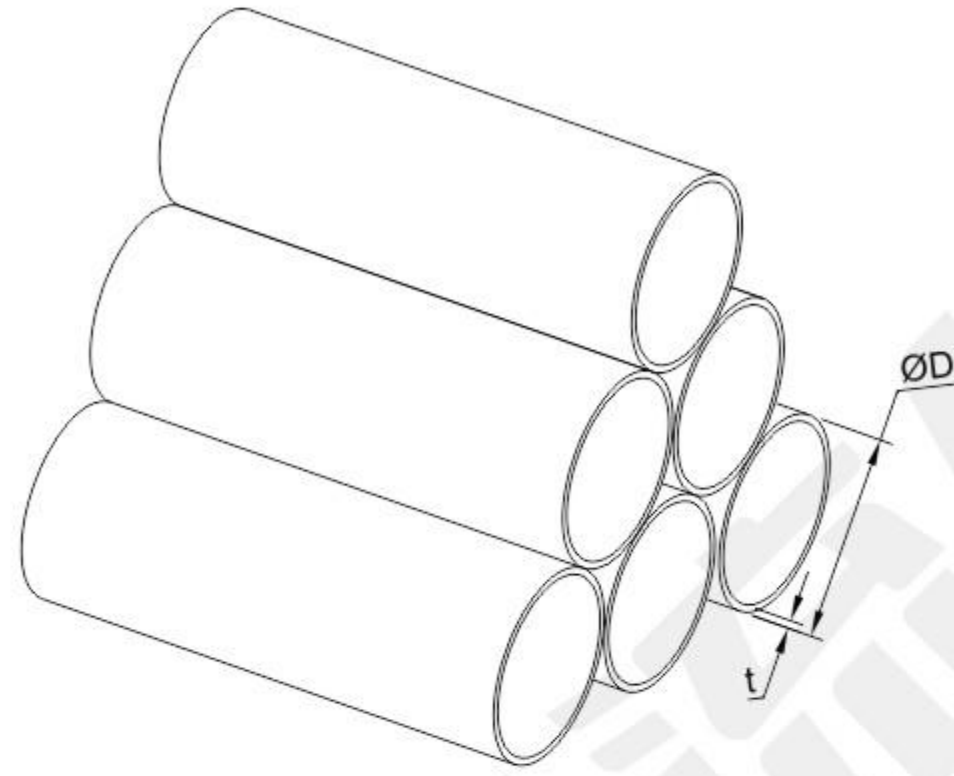

DIN11850			3A			SMS/DS		
Size	D×t	D×t	Size	D	t	Size	D	t
DN10	12×1.5	13×1.5	1/2"	12.7	1.65	19	19.1	1.25/1.5
DN15	18×1.5	19×1.5	3/4"	19.05	1.65	25	25.4	1.25/1.5
DN20	22×1.5	23×1.5	1"	25.4	1.65	32	31.8	1.25/1.5
DN25	28×1.5	29×1.5	1 1/2"	38.1	1.65	38	38.1	1.25/1.5
DN32	34×1.5	35×1.5	2"	50.8	1.65	51	50.8	1.25/1.5
DN40	40×1.5	41×1.5	2 1/2"	63.5	1.65	63	63.5	1.6/2.0
DN50	52×1.5	53×1.5	3"	76.2	1.65	76	76.2	1.6/2.0
DN65	70×2.0	70×2.0	4"	101.6	2.1	89	88.9	2.0
DN80	85×2.0	85×2.0	6"	152.4	2.8	102	101.6	2.0
DN100	104×2.0	104×2.0	8"	203.2	2.8			
DN125	129×2.0	129×2.0						
DN150	154×2.0	154×2.0						
DN200	204×2.0	204×2.0						
	Series 0 系列0	Series 2 系列2						

ISO/IDF			ISO 2037		ISO 1127		BS 4825	
Size	D	t	D	t	D	t	D	t
12.7	12.7	1.5	12.7	1.2	13.5	1.6	12.7	1.6
19	19.1	1.5	17.2	1.2	17.2	1.6	15.88	1.6
25	25.4	1.5	21.3	1.2	21.3	1.6	19.05	1.6
32	31.8	1.5	25.0	1.2	26.9	1.6	25.4	1.6
38	38.1	1.5	33.7	1.2	33.7	2.0	38.1	1.6
45	45.0	2.0	38.0	1.2	42.4	2.0	50.8	1.6
48	48.0	1.5	40.0	1.2	48.3	2.0	63.5	1.6
51	50.8	1.5	51.0	1.2	60.3	2.0	76.2	1.6
57	57.0	2.0	63.5	1.6	76.1	2.0	101.6	2.0
63	63.5	2.0	70.0	1.6	88.9	2.3	114.3	2.0
76	76.2	2.0	76.1	1.6	114.3	2.3	139.7	2.0
89	89.0	2.0	88.9	2.0	139.7	2.3	168.3	2.5
102	101.6	2.0	101.6	2.0	168.3	2.3	219.1	2.5
108	108.0	2.0	108.0	2.0	219.1	2.3		
114	114.3	2.0	114.3	2.0				
133	133.0	2.5	139.7	2.0				
159	159.0	2.5	168.3	2.6				
204	204.0	2.5	219.1	2.6				

各国不锈钢牌号
Stainless Steel Standards of Different Countries

中国	欧盟	美国	美国	英国	德国	日本
GB (China)	EN (Europa)	AISI (U.S.A)	ASTM (U.S.A)	BSI (U.K)	DIN (Germany)	JIS (Japan)
0Cr18Ni9	X5CrNi18-10	304	TP304	304 S 15 304 S 16	1.4301	SUS304
00Cr19Ni10	X2 CrNi9-11	304L	TP304L	304 S 11	1.4306	SUS304L
0Cr17Ni12Mo2	X5CrNiMo17-2-2	316	TP316	316 S 31	1.4401	SUS316
00Cr17Ni14Mo2	X2CrNiMo17-2-2	316L	TP316L	316 S 11	1.4404	SUS316L

化学成分与力学性能
Chemical Composition and Mechanics Property

中国 (GB)	钢种	碳	硅	锰	磷	硫	铬	钼	镍	力学性能			
		≤ C	≤ Si	≤ Mn	≤ P	≤ S	Cr	Mo	Ni	屈服强度 σ _{0.2} (Mpa) ≥	抗拉强度 σ _b (Mpa) ≥	延伸率 δ 5 %	硬度 HB ≤
中国 (GB)	304	0.07	1.0	2.0	0.035	0.030	18.0-20.0	/	8.0-11	205	520	40	187
	304L	0.03	1.0	2.0	0.035	0.030	18.0-20.0	/	8.0-12	177	480	40	187
	316	0.08	1.0	2.0	0.035	0.030	16.0-18.5	2.0-3.0	10-14	205	520	40	187
	316L	0.03	1.0	2.0	0.035	0.030	16.0-18.0	2.0-3.0	12-15	177	480	40	187
美国 (ASTM)	TP304	0.08	0.75	2.0	0.040	0.030	18.0-20.0	/	8.0-11	205	515	35	187
	TP304L	0.035	0.75	2.0	0.040	0.030	18.0-20.0	/	8.0-13	170	485	35	187
	TP316	0.08	0.75	2.0	0.040	0.030	16.0-18.0	2.0-2.5	10-14	205	515	35	187
	TP316L	0.035	0.75	2.0	0.040	0.030	16.0-18.0	2.0-2.5	12-15	170	485	35	187
日本 (JIS)	304	0.08	1.0	2.0	0.040	0.030	18.0-20.0	/	8.0-11	206	520	35	187
	304L	0.03	1.0	2.0	0.040	0.030	18.0-20.0	/	9.0-13	177	481	35	187
	316	0.08	1.0	2.0	0.040	0.030	16.0-18.0	2.0-3.0	10-14	206	520	35	187
	316L	0.03	1.0	2.0	0.040	0.030	16.0-18.0	2.0-3.0	12-16	177	481	35	187
美国 (AISI) 英国 (BSI) 德国 (DIN) 欧盟 (EN)	304	0.07	1.0	2.0	0.045	0.015	17.0-18.0	/	8.0-10	205	520	40	187
	304L	0.03	1.0	2.0	0.045	0.015	17.0-18.0	/	8.0-10	180	480	40	187
	316	0.08	1.0	2.0	0.045	0.015	16.5-18.0	2.0-2.5	10-13	205	520	40	187
	316L	0.03	1.0	2.0	0.045	0.015	16.5-18.0	2.0-2.5	10-13	180	480	40	187



No. KST - PUMP - A
ST-F3004

周泰自吸泵又称CIP回程泵，其泵体部分材料，均为耐酸不锈钢制成（AISI 316），耐酸碱腐蚀特性，尤为显著，符合食品卫生要求。

周泰离心泵的特性，在于能吸取混有空气或泡沫的液体，甚至能在只有空气时，照样自行抽吸，该泵是容积式泵，广泛用于液位低于泵的吸取物料，如在吸奶间，可将奶自奶桶中吸出或可在自动CIP清洗系统中，作为清洗缸的回程泵，机械密封为内装内流式，吸取物料温度不高于100℃。



ST-F3005

Also known as CIP return pump kingstone pump, the pump part of the materials, are acid-resistant stainless steel (AISI 316), acid and alkali resistance properties, is particularly significant, in line with food hygiene requirements.

Characteristics better than centrifugal pump means that it can absorb liquid mixed with air or foam, and can conduct self-sucking when there is only air. This pump belongs to positive displacement pump and is widely used to suck material when liquid level is below pump. For example, it can suck milk from milk can, or can be considered as pullback pump of cleaning tank in automatic CIP cleaning system. Mechanical seal is internal installation inward flow type, and sucked material temperature is not higher than 100℃.

- 材质:304/316L
- 密封方式:机械密封
- 连接方式:螺纹、焊接、快装

尺寸 mm

性能	主要参数		
型号	20T/24M	30T/24M	40T/36M
流量 Q	20T	30T	40T
总扬程 H	24M	24M	36M
其中吸程	5-6M	5-6M	5-6M
叶轮轮幅直径	192	192	φ215
进出口管径	63.5/63.5	76/63.5	76/76
电动机型号	ABB/GB	ABB/GB	ABB/GB
功率	5.5KW(380V.50HZ)	7.5KW(380V.50HZ)	11KW(380V.50HZ)
转速	1450/2850 r/min	1450/2850 r/min	1450/2850 r/min
外型尺寸(长 x 宽 x 高)	760x320x475	760x320x475	1006x360x600
机器重量	110kg	116kg	168kg

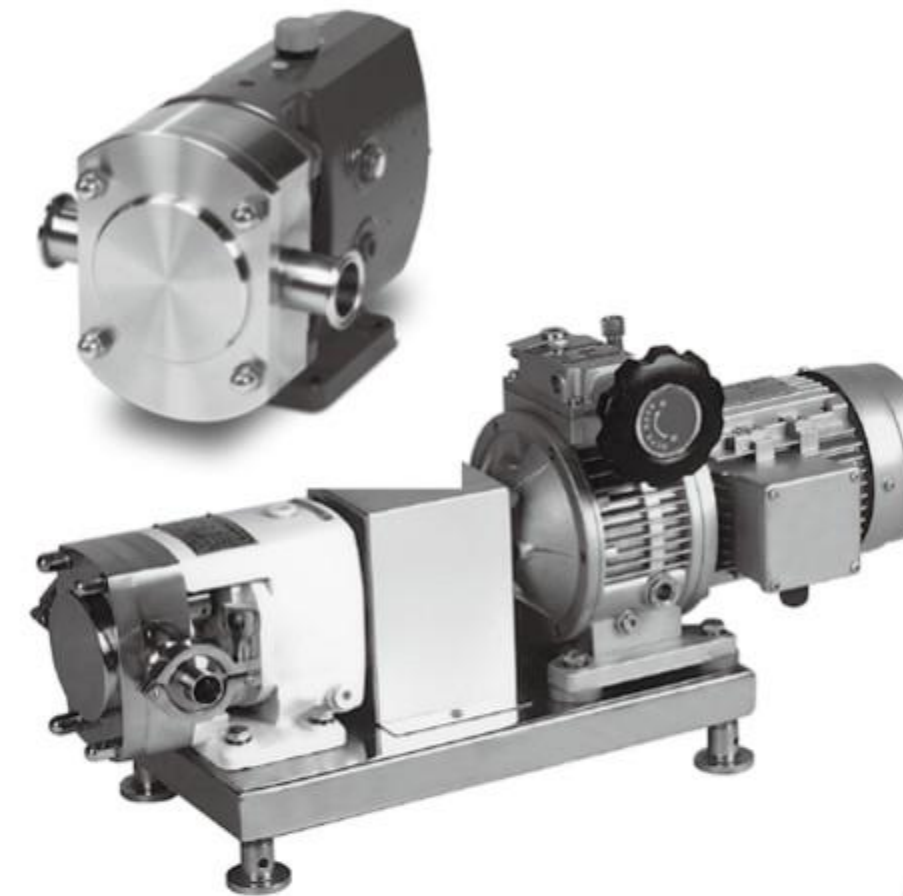

No. KST - PUMP - R

工作原理

转子泵又称胶体泵,三叶泵,鞋底泵等。依靠两同步反向转动的转子(齿数为2-4)在旋转过程中于进口处产生吸力(真空度),从而吸入所要输送的物料。两转子将转子室分隔成几个小空间,并按a→b→c→d的次序运转。运转至位置a时,只有I室中充满介质;到位置b时,B室中封闭了部分介质;到位置c时,A室中也封闭了介质;到位置d时,A、B室与II室相通,介质即被输送至出口。如此循环往复,介质(物料)即被源源不断地输送出。

Operation Principle

Rotor pump is also named rotary lobe epump, three-lobe pump, sole pump,etc. When the 2 simultaneous reverse rotating rotors(with 2-4 gears)revolve, it produces suction force at the inlet(vacuum),which intakes the material delivered.The 2 rotors divide the rotor housing into many smaller parts and revo-lve in the sequence of a→b→c→d.When it revolves to position a,only housing I is filled with medium;when it revolves to position b,housing B encloses part of the medium,when it goes to position c,housing A encloses medium,and finally it goes to position d,then housing A,B and II are interlinked and the medium is transported to the outlet.As this process is repeated, medium(material)is transpor- ted continuously.

工作原理图 Working Principle

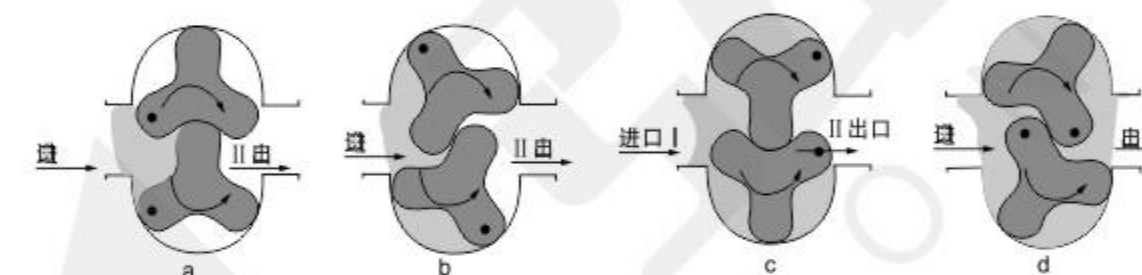

技术参数 Main parameter

产品型号 Model	每百转排量 (L) Liter/100Rew	建议调速范围 (RPM)	对应流量 (L/H) Flow rate	电机功率 (KW) Power
PD3A-3	3L	200-500	300-800	0.55
PD3A-6	6L	200-500	650-1600	0.75
PD3A-8	8L	200-500	850-2160	1.5
PD3A-12	12L	200-500	1300-3200	2.2
PD3A-20	20L	200-500	2100-5400	3
PD3A-30	30L	200-400	3200-6400	4
PD3A-36	36L	200-400	3800-7600	4
PD3A-52	52L	200-400	5600-11000	5.5
PD3A-66	66L	200-400	7100-14000	7.5
PD3A-78	78L	200-400	9000-18000	7.5
PD3A-100	100L	200-400	11000-22000	11
PD3A-135	135L	200-400	15000-30000	15
PD3A-160	160L	200-400	17000-34000	18.5
PD3A-200	200L	200-400	21600-43000	22

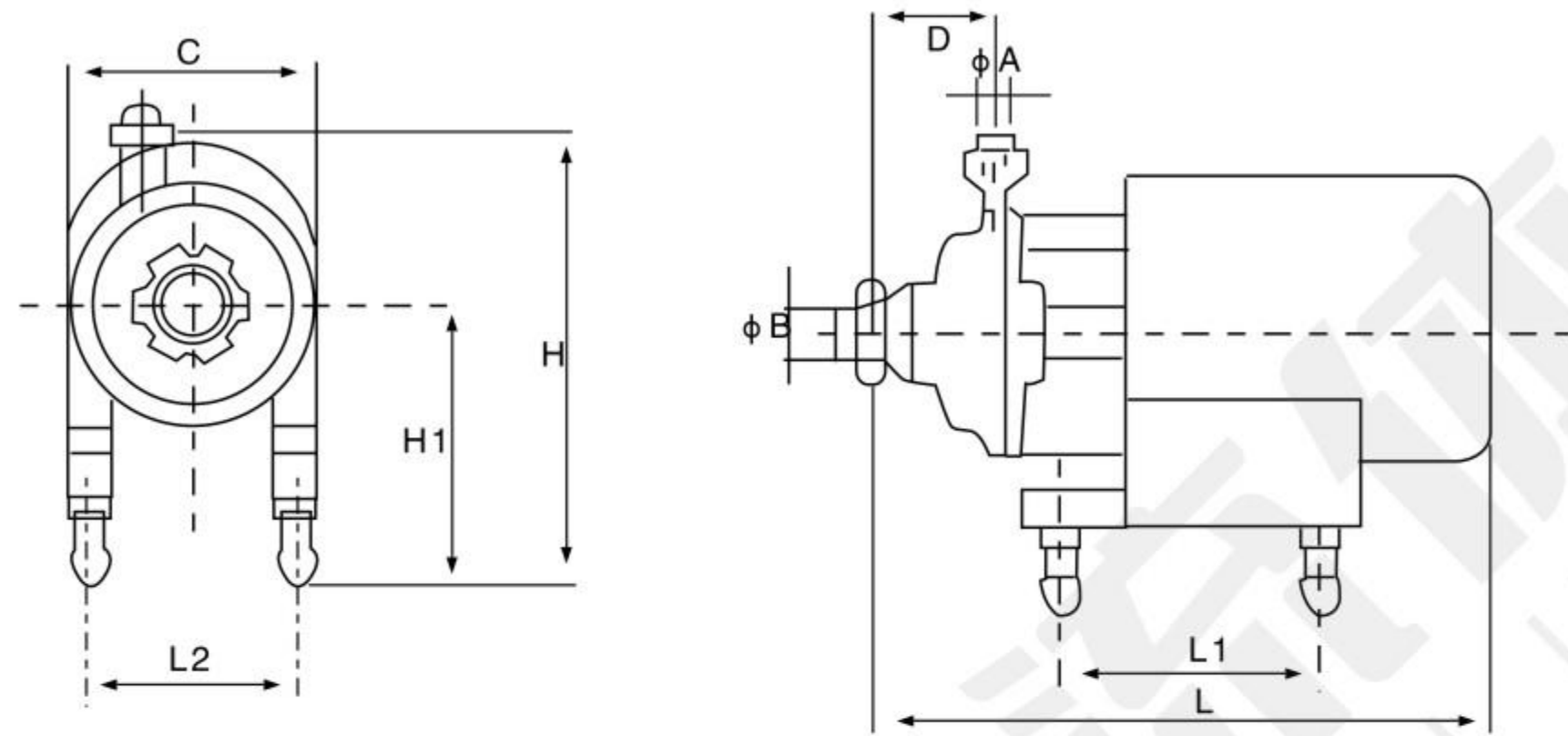

技术参数
Main parameter

型号	项目	A	B	L	L1	L2	H	H1	C	D
1.5T (14m)		32	25	500	165	112	260-280	140-160	250	68
3T (14m)		38	32	515	184	125	282-302	152-172	274	70
5T (24m)		38	38	580	200	140	302-322	152-172	300	80
5T (30m)		38	38	580	200	140	302-322	152-172	300	83
10T (24m)		38	51	590	230	140	400-450	220-270	300	88
10T (36m)		38	51	660	240	160	420-470	220-270	350	88
15T (24m)		51	51	660	240	160	420-470	220-270	350	97
15T (36m)		51	51	725	260	216	440-490	630-300	350	97
20T (24m)		51	51	660	240	160	420-470	220-270	350	97
20T (36m)		51	51	725	260	216	443-493	263-313	350	97
30T (24m)		51	63	725	260	216	443-493	263-313	350	97
30T (36m)		51	63	725	260	216	443-493	263-313	350	123
40T (36m)		63	63	950	450	250	570-620	350-380	500	123
80T (30m)		76	76	970	460	270	570-620	350-380	500	123
100T (50m)		76	101	1110	540	335	600-620	410-515	500	148
150T (50m)		101	125	1110	540	335	600-620	410-515	600	150
200T (50m)		125	150	1120	580	340	600-650	410-520	700	178

结构简图 (单密封)

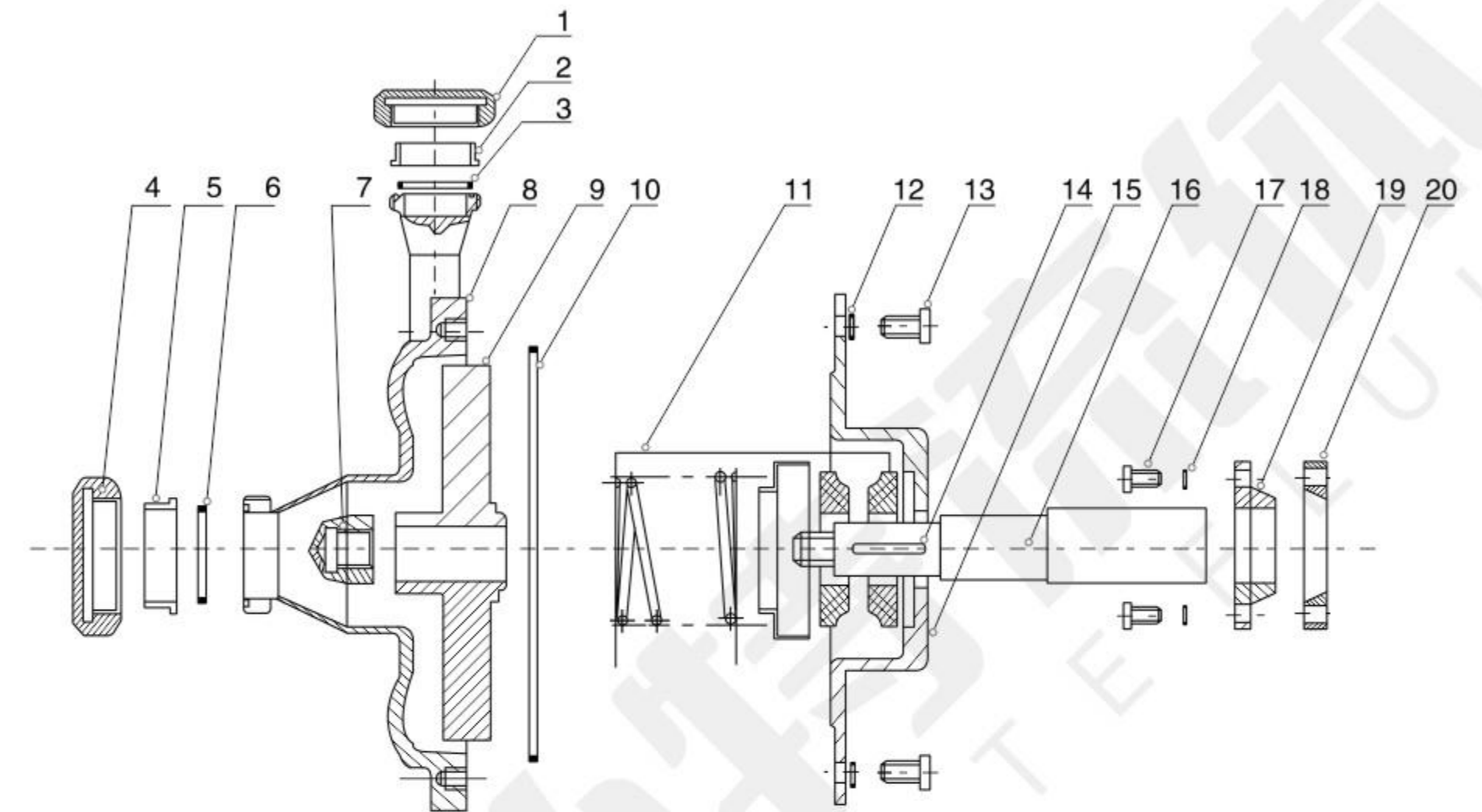

- | | |
|----------|---------|
| 1、出料口螺母 | 11、机械密封 |
| 2、出料口接管 | 12、垫圈 |
| 3、出料口密封圈 | 13、螺栓 |
| 4、进料口螺母 | 14、键 |
| 5、进料口接管 | 15、泵体 |
| 6、进料口密封圈 | 16、轴 |
| 7、螺母 | 17、螺栓 |
| 8、泵盖 | 18、垫圈 |
| 9、叶轮 | 19、夹箍 |
| 10、泵盖密封圈 | 20、夹箍圈 |



ST-F3001



ST-F3002

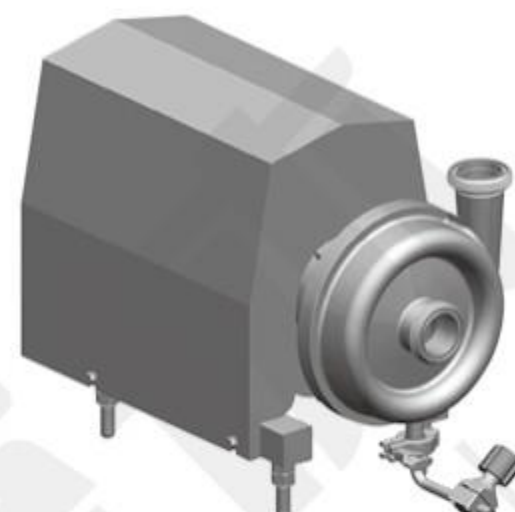

ST-F3003

技术参数
Main parameter

型号 Model	流量 (吨/小时) Ton/hour	扬程 (米水柱) Discharge head(m)	电动功率 Power(Kw)	进出口径 Inlet/Outlet	
ST-1.5-14	1.5	14	0.5	40/25	32/25
ST-3-14	3	14	1.1	40/32	38/32
ST-5-24	5	24	1.5	50/40	38/38
ST-5-30	5	32	2.2	50/40	51/38
ST-10-24	10	24	2.2	50/40	51/38
ST-10-36	10	36	3	50/40	51/38
ST-15-24	15	24	3	50	51
ST-15-36	15	36	4	50	51
ST-20-36	20	36	5.5	50	51
ST-20-24	20	24	4	50/50	51/51
ST-30-24	30	24	5.5	65/50	63/51
ST-30-36	30	36	7.5	65/50	63/51
ST-40-36	40	36	11	80/65	76/63
ST-80-30	80	30	15	100/80	101.6/76
ST-100T-50	100	50	22	125/100	
ST-150T-50	150	50	33	150/125	
ST-200T-50	200	50	45	150/125	

宽电压电机
Wide input range motor

功率 Power(Kw)	电压备注 Voltage	功率 Power(Kw)	电压备注 Voltage
0.55	210V-230V/50HZ	4	360V-400V-50HZ
0.75			
1.1			
1.5	360V-400V/50HZ	7.5	630V-690V-50HZ
2.2			
3	420V-460V/60HZ	11	420V-460V/60HZ
		15	
		18.5	
		22	
		30	